



SANTA CLARITA VALLEY AUSTRALIAN SHEPHERD CLUB

JUMP INTO SPRING TRIAL

ASCA Sanctioned Agility Trial Open to All-Breeds!

March 24, 25 & 26, 2023

| | | | |
|--|--|--|--|
| Judge | Sherry Butler | | |
| Classes Offered (tentative order) | Elite, Open, Novice | | |
| | Friday- Tall to Small | Saturday- Small to Tall | Sunday- Tall to Small |
| | One Ring Regulars 1 & 2 | Jumpers 1 & 2 Gamblers 1 Regular 3 & 4 Gamblers 2 | Gamblers 3 Regular 5 & 6 Gamblers 4 Jumpers 3 & 4 |
| Location | The Sweetwater Movie Ranch, 32500 Agua Dulce Canyon Road Agua Dulce, CA 91390 | | GATE WILL BE LOCKED UNTIL 2 PM ON FRIDAY |
| | Covered Arena on Sand | | |
| Entry Limits | <p>Entries are limited to 350 runs each day.</p> <p>Trial entries will close whenever this limit is reached.</p> <p>"Day Of" entries will be accepted, if the trial limit is not reached.</p> | | |
| Opening and Closing Dates | <p>Opening date is Monday, February 13, 2023</p> <p>Closing date is Monday, March 20, 2023 or when the entry limit is reached.</p> <p>After March 22, 2023, cancelled entries may be subject to limited refunds.</p> <p>Confirmations will be emailed to all who pre-enter.</p> <p>Please print your email address clearly on the entry form.</p> | | |

| | | | | | | | | | | | | | | | | | |
|---|--|---------------------|---------|----------------------------------|---------|------------------------------|----------|------------------------|----------|-----------------|---------|-------------------------------------|---------|--|---------|---|---------|
| Briefing Meeting | Starts at 5 pm on Friday, 8 am on Saturday & Sunday | | | | | | | | | | | | | | | | |
| Walk Through | Starts at 5:15 pm on Friday, 8:15 am on Saturday & Sunday | | | | | | | | | | | | | | | | |
| First Dog | On Line at 5:30 pm on Friday, 8:30 am on Saturday & Sunday | | | | | | | | | | | | | | | | |
| Trial Chair | Tammy Robinson, scvasclub@gmail.com | | | | | | | | | | | | | | | | |
| Send Payment to Trial Secretary | <p>Debbie Arias</p> <p>scvasclub@gmail.com</p> <p>661-755-0008</p> <p>24119 Del Monte Dr, Unit #55</p> <p>Valencia, CA 91355</p> | | | | | | | | | | | | | | | | |
| Entry Information | <table> <tr> <td>Each Run For Friday</td> <td>\$10.00</td> </tr> <tr> <td>Each Run for Saturday and Sunday</td> <td>\$14.00</td> </tr> <tr> <td>Two day package- all 12 runs</td> <td>\$140.00</td> </tr> <tr> <td>Additional Dog package</td> <td>\$100.00</td> </tr> <tr> <td>Junior each run</td> <td>\$10.00</td> </tr> <tr> <td>Junior two day package- all 12 runs</td> <td>\$95.00</td> </tr> <tr> <td>Day-of entry per run (no package deal)</td> <td>\$15.00</td> </tr> <tr> <td>Junior Day of entry per run (no package deal)</td> <td>\$12.00</td> </tr> </table> <p>Note: One dog per package; packages cannot be combined for multiple dogs.</p> <p>Make checks payable to SCVASC and mail with completed entry form to the Trial Secretary.</p> <p>Checks not honored by the bank do not constitute a valid entry fee. Checks returned by the bank will be charged a service fee of \$35.00.</p> | Each Run For Friday | \$10.00 | Each Run for Saturday and Sunday | \$14.00 | Two day package- all 12 runs | \$140.00 | Additional Dog package | \$100.00 | Junior each run | \$10.00 | Junior two day package- all 12 runs | \$95.00 | Day-of entry per run (no package deal) | \$15.00 | Junior Day of entry per run (no package deal) | \$12.00 |
| Each Run For Friday | \$10.00 | | | | | | | | | | | | | | | | |
| Each Run for Saturday and Sunday | \$14.00 | | | | | | | | | | | | | | | | |
| Two day package- all 12 runs | \$140.00 | | | | | | | | | | | | | | | | |
| Additional Dog package | \$100.00 | | | | | | | | | | | | | | | | |
| Junior each run | \$10.00 | | | | | | | | | | | | | | | | |
| Junior two day package- all 12 runs | \$95.00 | | | | | | | | | | | | | | | | |
| Day-of entry per run (no package deal) | \$15.00 | | | | | | | | | | | | | | | | |
| Junior Day of entry per run (no package deal) | \$12.00 | | | | | | | | | | | | | | | | |

CONFIRMATIONS of the classes you entered will be Emailed to all entrants who provide a valid email. PLEASE READ YOUR CONFIRMATIONS!! General information will be Emailed about a week before the trial with check-in time, walk through/start times, and tentative class running orders.

CLASS CHANGES: Moveups must be submitted in writing (Emails OK) and must be received by the Trial Secretary before 5:00 PM Friday, March 20, 2023. Moveups will be allowed at the trial from Saturday to Sunday – The moveup form will be posted at the score table. All move-up requests must be on the form within 30 minutes after the last class has finished on Saturday. NO Exceptions!

ACE PROGRAM: ASCA has two programs, ACE and Championship. Dogs entered in the ACE jump 4" lower than their CH STD jump height and get a bit more time. It's similar to USDAA or AKC performance. ACE dogs are not included in ASCA Finals. Dogs may be entered only in Championship or ACE. ACE has a Standard Division and a Senior Dog Division. See the latest ASCA Agility Rule Book at www.asca.org for more details

FEO: Dogs 15 months or older can be entered For Exhibition Only. Dogs less than 18 months of age will jump at least 4" lower jump height than their standard jump height. Dogs must be entered FEO on their entry form and cannot switch to a regular CH or ACE class at the trial. FEO dogs will be scored by the judge like other dogs. If the dog completes the course, a time and any faults will be recorded but qualifying runs do not apply. IF the dog does not complete the course, it may be eliminated for "training in the ring."

TOYS IN THE RING: Toys will be allowed in the ring for training (no squeaky toys and no toys with food). Mark a "T" on the gate sheet to indicate you will be using a toy. Handlers using toys will run in their regular order. When you enter the ring, show the judge your toy

NOVICE A or NOVICE B: Novice A is for dogs, owners, and handlers who have never earned an agility title in any venue.

AWARDS: SCVASC offers ribbons for First through Fourth place in each class for each jump height division. 20+" and 24" dogs will be scored together. ASCA Qualifying Ribbons will be offered to every dog obtaining a qualifying score. Dogs that complete an ATCH/ACE receive a large rosette and a decorated pole for signing. Please let us know if you are close to your ATCH/ACE

HIGH IN TRIAL AWARDS will be awarded to the highest scoring dog(s) in the following categories (6 awards in all) in the Novice, Open and Elite levels (CH Standard division), Junior CH division, Veteran Dog CH Division and overall ACE. A dog's category will be based upon the level/division in which the dog competes in its last Regular class. All Qs are counted. Qs receive 5 points for Novice, 6 points for Open and 7 points for Elite. Faulted Qs received ½ the value. High point dog in each category is the winner. The average YPS in Regular is the tie breaker.

EQUIPMENT LIST: Rubberized 5'6" A-Frame and dog walk and teeter. Jumps, tunnels, 24" weave poles, displaceable tire. Electronic timing will be used.

FOOD: There will be a continental breakfast and lunch for everyone who has entered a dog(s).

PERMANENT MEASUREMENT CARDS – Dogs with a standard jump height of 20+" or greater do not need to be measured. All other heights must be measured or you must present an ASCA, NADAC or AKC permanent height card, or USDAA website printout of dog's measurement for a permanent jump height card. Copy of permanent jump height card can be sent with entry

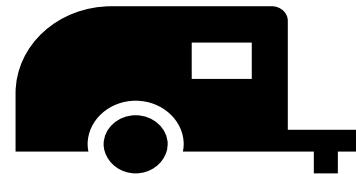

RVs AND OVERNIGHT PARKING FOR RVs AT THE SHOW SITE: Overnight RV parking will be available for \$35 per night by pre-arrangement. No exit or entry from 10 pm to 6 am. Overnight spaces will be assigned and must be reserved in advance; permits will be available at check in. **NO GENERATORS AFTER 10PM.**

NOTICE TO EXHIBITORS

Safety shall always be the foremost consideration in actions and conduct by handlers at all times. In all cases, regardless of the situation, the judge's decision is final.

Junior Handlers: Junior Handlers are under 18 years.

Refunds: No refund is given if a dog or handler is dismissed from competition, regardless of the reason. The trial will not be cancelled in the event of rain. Refunds of 50% of the entry fees paid will be issued for injured dogs or bitches in season if submitted to the trial secretary in writing by 8 a.m. by Wednesday, March 22, 2023.

This trial will be held under the current rules and regulations of ASCA. Exhibitors, through submission of entry, acknowledge that they are knowledgeable of ASCA rules and regulations, and agree to abide by all rules in effect at the time of this trial. A copy of ASCA's Agility Rulebook may be downloaded free from the ASCA web site: www.asca.org. [ASCA QT Number and Service Membership Application https://asca.org/wp-content/uploads/2022/06/qtsvcapp.pdf](https://asca.org/wp-content/uploads/2022/06/qtsvcapp.pdf)

No entry shall be accepted from a dog or handler disqualified from the ASCA agility or all ASCA programs; or a member/person not in good standing with ASCA. The Trial Committee may refuse any entry on the basis expressly provided through ASCA rules and regulations or guidelines established by the ASCA Board of Directors.

****No set up within 15' of the ring. All dogs must be on leash when not competing.**

Please clean up after your dog!

Please keep hotel rooms and premises clean so hotels continue to accept dogs.

The Trial Committee will not be responsible for the loss or damage to any dog exhibited, or for the possessions of any exhibitor whether the result was by accident or any other cause.

It is distinctly understood that every dog at this event is in the care, custody, and control of his/her owner or handler during the entire time the dog is on the trial premises. Please take responsibility for your dogs and children. Any exhibitor whose dogs or children create unnecessary disturbances or repeatedly engage in unsafe or disruptive behavior may, at the discretion of the Trial Committee, be asked to leave. There will be no refunds for entries if a dog or handler is dismissed from competition for any reason.



RV REQUEST FORM

If you want an RV spot, please fill out and mail with your entry form
Any questions, please contact Tammy Robinson at scvasclub@gmail.com

NO GENERATORS AFTER 10 PM PLEASE

Name: _____

Address: _____

Phone: _____

Email address: _____

Nights Staying (circle): Friday Saturday

Type of Vehicle (circle): RV Class A / C Trailer Van

Side-Outs (None, Left, Right, Both): _____

Length (feet, including hitching racks): _____

Vehicle Plates: _____

Total RV fees enclosed (RV \$35/night) _____

ALL SET UPS ARE AFTER 2:00 PM ON FRIDAY

**PLEASE DO NOT COME EARLY.
THE GATE WILL NOT BE UNLOCKED
BEFORE 2:00 PM ON FRIDAY**

CAN YOU HELP??

It takes a lot of people to put on an agility trial. We cannot run this trial without your help! Most jobs can be learned in a few minutes.

We will have a white board for sign ups at the trial site each day.
Please sign up to help.

ACCOMMODATIONS IN SANTA CLARITA THAT ACCEPT DOGS

Please verify the hotel's/ motel's pet policy before making your reservation to make sure they still accept dogs.
Please let us know if they don't.

| | |
|---|--|
| Super 8 by Wyndham Santa Clarita/Valencia 17901 Sierra Hwy Santa Clarita 1-855-516-1092 | Los Angeles RV Resort & Glamping 7601 Soledad Canyon Road Action 1-800-5622172 |
| Sierra Pelona 12117 Sierra Hwy Santa Clarita 661-252-1700 | Thousand Trails Campground With Cabins 4700 Crown Valley Road Action 661-269-1740 |

DRIVING DIRECTIONS: Take freeway 14 to Agua Dulce Canyon Road. Turn North to address 32500, on your right. Look for the entrance sign. Our club will be posting it out by the road.

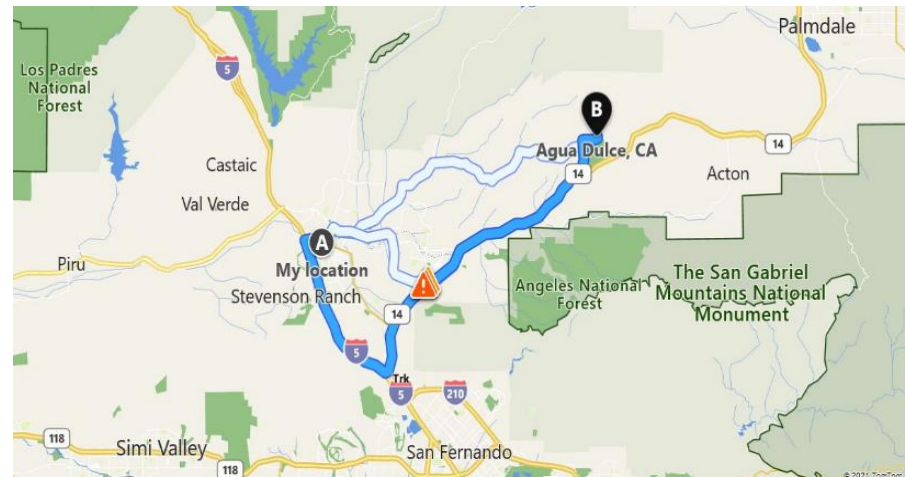

SANTA CLARITA VALLEY AUSTRIAN SHEPHERD CLUB

All Breed Agility Trial Entry Form - March 24-26, 2023, 2023

When completed make check payable to SCVASC and mail to:

Debbie Arias, 24119 Del Monte Dr., Unit 55, Valencia, Ca 91355

661-755-0008 scvasclub@gmail.com

Opening date is March 13, 2023

Pre-Entries close Monday, January 23, 2023. Day of entries may be available at \$15.00 per run

Use one entry form per dog. Please print or type the following information.

| | |
|-----------------------------------|------|
| ASCA Registration or QTracking #: | DOB: |
|-----------------------------------|------|

| | | | | | | |
|---------------------------------|-----|-----|--------|----------------|------|--------|
| REGISTERED NAME | | | | | | |
| DOG'S CALL NAME | | | | BREED: | | |
| Jump Hght. Exp ? Circle one | YES | NO | | SEX circle one | Male | Female |
| Dogs wither height | | | | | | |
| Standard Jump Height circle one | 8 | 12 | 16 | 20 | 20+ | 24 |
| Program circle one | CH | ACE | FEO | | | |
| OWNER: | | | | | | |
| ADDRESS: | | | | | | |
| CITY, STATE, ZIP: | | | | | | |
| PHONE: | | | EMAIL: | | | |

| Class Entered | DIVISION | | | | LEVEL | | | DAY(s) ENTERED | | |
|---------------|----------|-----|------|------------------|----------------------|------|-------|----------------|-------|-------|
| | Std | Vet | JR.H | Senior Dog (Ace) | NOVICE circle a or b | OPEN | ELITE | DAY 1 | DAY 2 | DAY 3 |
| Reg R1 | | | | | A or B | | | | | |
| Reg R2 | | | | | A or B | | | | | |
| Jumpers 1 | | | | | | | | | | |
| Jumpers 2 | | | | | | | | | | |
| Gamblers 1 | | | | | | | | | | |
| Gamblers 2 | | | | | | | | | | |

| | | |
|--|----------|-------|
| Entry Fee per Class- Friday \$10.00 | Total \$ | _____ |
| Entry Fee per Class- Saturday & Sunday \$14.00 | Total \$ | _____ |
| Two day package-Saturday & Sunday (all 12 runs) \$140.00 | Total \$ | _____ |
| Additional Dog package- Saturday & Sunday \$100.00 | Total \$ | _____ |

\$15.00 PER CLASS ON DAY OF TRIAL **Total Entry Fee Enclosed \$** _____

AGREEMENT
IMPORTANT LEGAL AGREEMENT—Please read the following carefully as it, among other things, may prevent you from suing ASCA® and persons/entities affiliated with it. This agreement could even require you to defend them from demands and suits by third parties that include an assertion of wrongdoing by you. (1) The person signing this Agreement represents being authorized to enter into it on behalf of him/herself, as well as (if different) the owner(s)/exhibitor(s)/handler(s) of the dog(s) for which an entry form is being submitted (all these parties collectively referred to herein as "Applicant"). (2) "Releasees" here collectively refers to the Australian Shepherd Club of America® (ASCA®); its affiliate clubs; and the officers and board of directors, staff, contractors, insurers, attorneys, and agents of ASCA® and of those clubs. (3) This Agreement voluntarily is entered into by Applicant in exchange for the acceptance of the associated entry form and permission to participate in related activities. (4) Applicant agrees to abide by the rules and regulations of ASCA® and any other rules and regulations applicable to this event. (5) Applicant certifies that the entered dog will not pose a hazard to people, property, stock animals, or other dogs, and further that the dog is current with rabies shots along with any other vaccinations required by its state of residence. (6) Applicant acknowledges and assumes the risks to Applicant and Applicant's dog associated with participation in the event, among which could be ones associated with poor condition of the facilities and surrounding areas; security measures or lack of them; electrical appliances; fittings; show rings; the presence of unfamiliar persons; and the presence/involvement of other animals—whether stock, dogs, or otherwise. (7) Applicant further agrees to comply with all recommended and required health and safety precautions, among which may be those related to social distancing; quarantining; wearing of face coverings; and non-participation of persons exhibiting symptoms or for whom there otherwise has been a likelihood of recent exposure to COVID-19 or other contagious diseases. (8) Applicant additionally acknowledges and agrees to assume the risks associated with taking part in the event though others might neglect compliance with health and safety precautions/requirements or pose an undue risk of spreading disease. For example, as is true as to any public event, there is some risk that Applicant and/or those affiliated with Applicant may catch COVID-19 or another contagious disease at the event. (9) To the maximum extent permissible, this release is to be interpreted under Texas law, without application of its choice of law rules. (10) To the extent that Applicant—or another party suing on behalf of Applicant, or suing to recover based on injuries/death/damage to Applicant/Applicant's dog/Applicant's property—sues ASCA® (or a board member or staff member or agent of ASCA®) as a defendant, the sole appropriate forum (to the maximum extent permitted by law) for the suit shall be the state or federal courts serving Brazos County, Texas (where ASCA® has its headquarters). (11) Applicant hereby releases and waives any claims Applicant otherwise might assert against the Releasees as to any injury or damage claim connected in any way to any alleged act or omission arising out of, or occurring concurrent with, the event and related activities, interactions, communications, and even adjacent premises. (12) This release is made not only as to Applicant but also for anyone who might assert a claim on behalf of Applicant or based on purported injury or damage to Applicant/Applicant's dog/Applicant's property, as well as any heir, beneficiary, assignee, executor, trustee, agent, or survivor of Applicant. (13) Applicant further agrees to assume sole responsibility for and indemnify and hold Releasees harmless from related claims, demands, judgments, and settlement payments. (14) These waiver, release, and indemnification provisions extend even to claims or demands asserting that the acts or omissions resulted in bodily injury or death or from intentional wrongdoing, as well as to attorney fees and other costs of defense. (15) The duties of indemnification further extend to any claims or demands asserted against Releasees that are alleged to have arisen out of the acts or omissions of Applicant, Applicant's dog, or others affiliated with Applicant. Among other things, this means that Applicant would pay the legal defense of Releasees if someone sued them based on a claim Applicant carelessly exposed the claimant to COVID-19. (16) Applicant's promises in this agreement apply without regard to the type of claim or cause of action asserted against Releasees. (17) To the extent any provision of this agreement is unenforceable, the remainder of it nonetheless is to be enforced. (18) This agreement is to be interpreted to provide Releasees with the maximum permissible legal protection from—among other things—claims and suits pursued by Applicant (and/or those acting on behalf of Applicant or over injury/damage to Applicant), as well as from ones based on the purported wrongful acts or omissions of Applicant. (19) Nothing in this Agreement requires you to indemnify Releasees from claims by third parties that involve no allegations of improper acts or omissions by you, those affiliated with you, nor your dog(s). (20) Applicant acknowledges having read, understood, and had the opportunity for independent legal review of this document prior to signing it.

Date: _____

SIGNATURE OF OWNER/HANDLER OR PARENT/LEGAL GUARDIAN (IF JR IS UNDER 18)
 PERSON SIGNING THIS FORM IS RESPONSIBLE FOR ALL ERRORS AND RULE VIOLATIONS
 AS USED HERE, "ASCA®" MEANS THE OWNER AND THE OPERATOR OF THE EVENT PREMISES, THE AUSTRALIAN SHEPHERD CLUB OF AMERICA, ITS AFFILIATE CLUBS, AND EACH OF THEIR MEMBERS, OFFICERS, DIRECTORS, EMPLOYEES, SHOW CHAIRMEN, SHOW COMMITTEES AND AGENTS.

32500 Ranch Drive Cyn Rd
ENTRANCE

Additional Parking

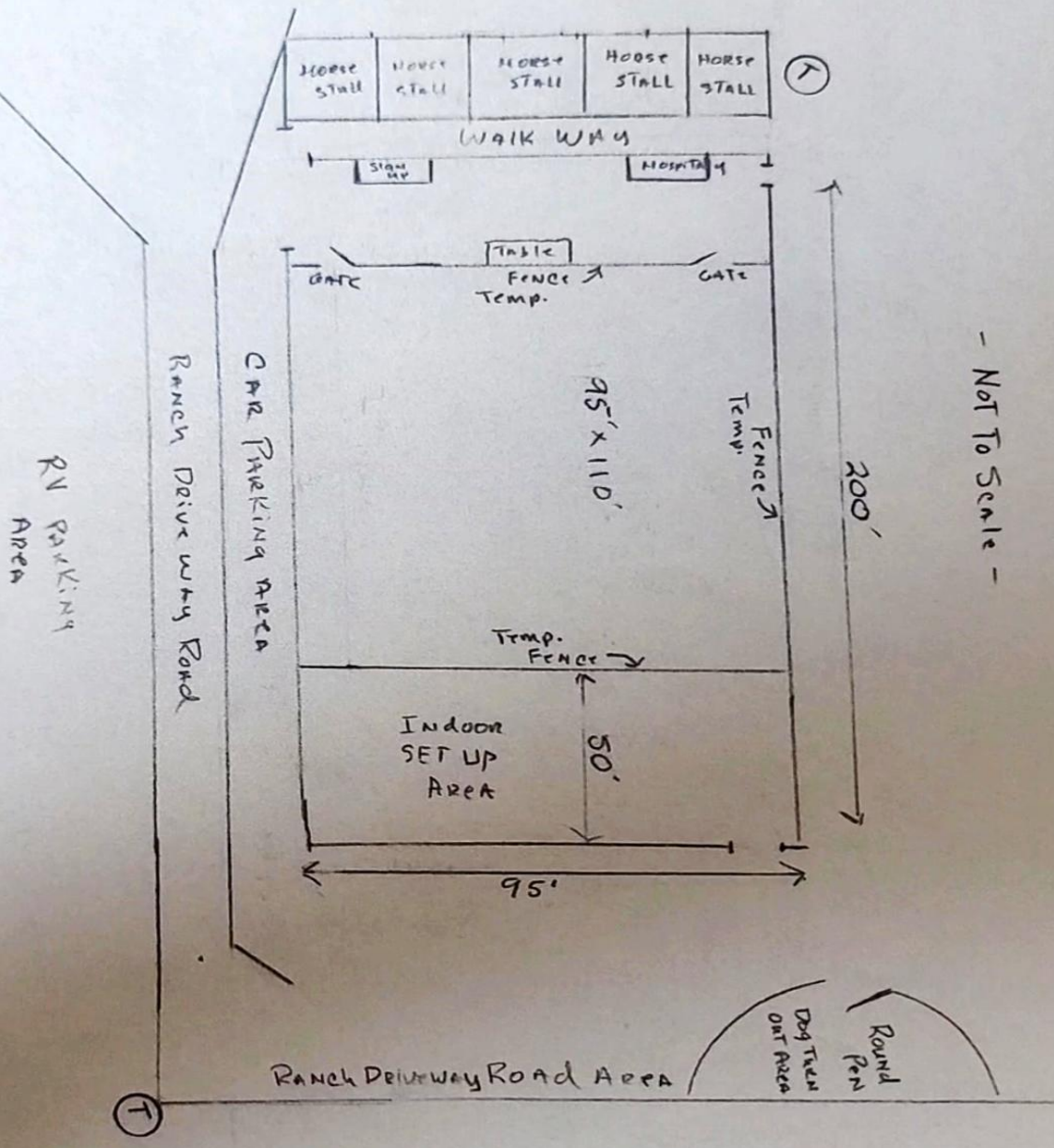

- NOT TO SCALE -

SANTA CLARITA VALLEY AUSTRALIAN SHEPHERD CLUB
EQUIPMENT LIST- MARCH 24-26, 2023 TRIAL

4 ea Jumps, winged
15 ea Jumps, non-winged
1 ea Teeter
1 ea A-Frame
1 ea Dog Walk
1ea 20' Tunnel
2 ea 15' Tunnel
1 ea 12 Pole Weave
1 ea 6 Pole Weave
Several Tunnel Bags